

## Pay in Cash

Please prepare coins. You can exchange only coins or 1,000 yen bills in the bus.

When getting on the bus



Boarding ticket sample

Take a boarding ticket

Please take 1 boarding ticket per person when getting on. Keep this ticket until you get off the bus, as it is to confirm from which stop you took the bus, and has to be put into the fare box with the fare when getting off. ※There are no boarding tickets at the first bus stop.

Fare table



Next bus stop

How to see the faretable

Please check the fare on the fare table at the front of the bus. It shows the fare for getting off at the next bus stop.



Boarding ticket No.

Fare

Monitor in the bus

How to see the monitor in the bus

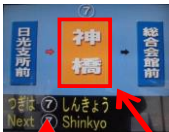

Next bus stop name

Next bus stop No.

Each bus stop of Tobu Bus Nikko has a number. Please check the bus No. to get off on the monitor in the bus.

When the bus stop to get off is announced (shown)

Press the button



The buttons are at the front of the bus. Please press the button when the bus stop to get off is shown on the fare table or monitor. Then all buttons will be illuminated as the sign that the bus will stop at the next stop.

Check the fare and prepare the amount

When getting off the bus



Cash feed port

Put the boarding ticket and fare into the fare box

Please put the "boarding ticket" and fare into the fare box next to the driver seat. Please note that you cannot get change.

## Pay with IC Card



When getting on the bus



IC card reader

Touch the card reader

Please touch the IC card reader at the entrance with your IC card.

If the bus stop to get off is announced (shown)



When getting off the bus

IC card reader



Touch the card reader

Please touch the IC card reader on the fare box with your IC card. If the balance is short, please pay the rest in cash or charge your card. You can charge in 1,000 yen units.

## Use Free Pass, etc.

When getting on the bus

When getting off the bus



Each passenger should hold their own ticket and show it clearly to the bus driver.

## How to exchange in the bus

Coin exchanger



Bill exchanger

Money changers are next to the fare box next to the driver seat. Please note that only coins and 1,000 bills can be exchanged. Please exchange while the bus stops, as it is dangerous when the bus is moving. ※2,000 / 5,000 / 10,000 yen bills cannot be exchanged.

## Information on the fare box machine

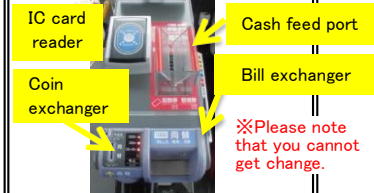

※Please note that you cannot get change.

## How to take buses (depending on the bus type)

①



Get off

Get on

②



Get off

Get on

③



Get on & off

④



Get on & off

Get on & off from the front door for big size buses such as ③④.